



Karndean
Designflooring

Karndean
LooseLay

LOOSE LAY

Karndean LooseLay

Your **Design**flooring journey starts here



Why Karndean?

At Karndean, we see flooring differently.

We travel the world in our quest to bring you exceptional floors that inspire and delight. From the ancient forests of Europe, to the remote Australian outback and beyond, we seek out expressive and intriguing forms in the natural world to influence our unique floor designs. By combining these original features with cutting edge design, we create simply beautiful floors that you'll love for a lifetime.



From *our* home

It all began in 1973 when a former flooring installer created a small family business from his family home.

With the belief that luxury vinyl flooring shouldn't just be practical, it needed to be beautiful as well, Karndean was formed. The team set out to travel the world, seeking inspiration from natural materials for what now are the most realistic luxury vinyl flooring products on the market.

The Karndean team worked out of that house for several years with the family's trusty dog, Smokey, the Great Dane who is still present on Karndean's logo today. For the family and Karndean's early employees — many who are still working with us today — these years bring back many fond memories.

Now stretching across the globe, beyond the walls of the original house, the Karndean family and employees continue to move forward with the same passion to deliver beautiful, innovative designs for your home.





to *your* home

Designing your home can be overwhelming. There are many elements that must fit together, from furniture to flooring, to fixtures and everything in between. Where to begin?

We begin a new design with an inspiration, and we are most inspired by nature. What's your design motivation? Is it aesthetic, such as a throw pillow or the perfect paint chip? Or is it lifestyle, a place where you can dance in your pajamas and your babies (both two- and four-legged) can roll around and play?

No matter what drives you, Karndean was created with your needs in mind. We see flooring differently and by combining our original features with cutting edge design, you can create a simply beautiful floor that you will love for a lifetime.

Our simple method will help you navigate the selection process and design your perfect floor, taking you beyond picking a colour and measuring the room. Let's get started!



KARNDEAN REAL HOMES
Meet Marcos and Lotta
and find out their inspiration

Scan this QR Code or visit
karndean.com/marcosandlotta





How to use this book

From Print to Digital - design *your* floor, *your* way



Mark it up

YOUR DESIGN BLUEPRINT

This book is yours to sketch, doodle, draw and plan. Chock-full of content to help inspire your design journey, take full advantage and get creative.

Try our digital tools

GO MOBILE

Use our digital tools to help you choose your floor and visualize it in your space. Meet current Karndean customers and read their testimonials. Discover how Karndean will work for you.

Take it offline

VISIT US

The Karndean design team is ready to work with you. Visit karndean.com and enter your postal code to find your local retailer. Bring this book with you and let's put your dream floor renovation into action.

There is more to this book.
Keep an eye out for QR Codes
that link to tools, videos and more.

Scan me with
your camera!

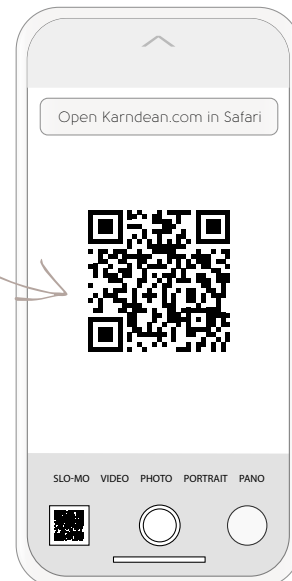



Your Home, *Your* Design, *Your* Choice

Browse our designs

Start online by filtering the designs you like by colour, size, format and more.

Floorstyle

Upload a picture of your home and get creative. Explore your options by changing your laying pattern, picking your paint colours, and mixing designs.

Bring it to life

Order a sample or visit your local retailer to see the product details and texture.



Floorstyle

Floorstyle allows you to design
your space, *your* way

Start from
your sofa



Scan this QR Code or visit
karndean.com/floorstyle



Your Town, *Your* Retailer, *Your* Choice

Share your vision

Visit your retailer for recommendations on design, layout, transitions and more!

Pick your colour

Look at the colour, texture and design to find the Karndean collection that works best for your home.

See it in your home

Bring a sample home to see how the design will look in your space with your lighting, fixtures and colour scheme.

Visit *your*
retailer



Scan this QR Code or visit
[karndean.com/findaretailer](https://www.karndean.com/findaretailer)

Visualize *your* space

Looking for inspiration but
unsure where to start?

Try our interactive room viewer, Floorstyle, a revolutionary digital tool that provides not only room inspiration, but a realistic view of just how beautiful Karndean floors can look in your space.

Whether you're looking for wood or stone flooring, simply upload your own photo or choose one of our pre-set room images and immediately begin designing. Once you've decided on your favourite design, you can order samples, save your work, or print and share it with your retailer.

Try it today on your computer, tablet or mobile phone.

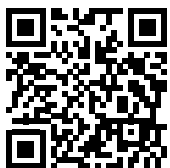

Scan this QR Code or visit
karndean.com/floorstyle



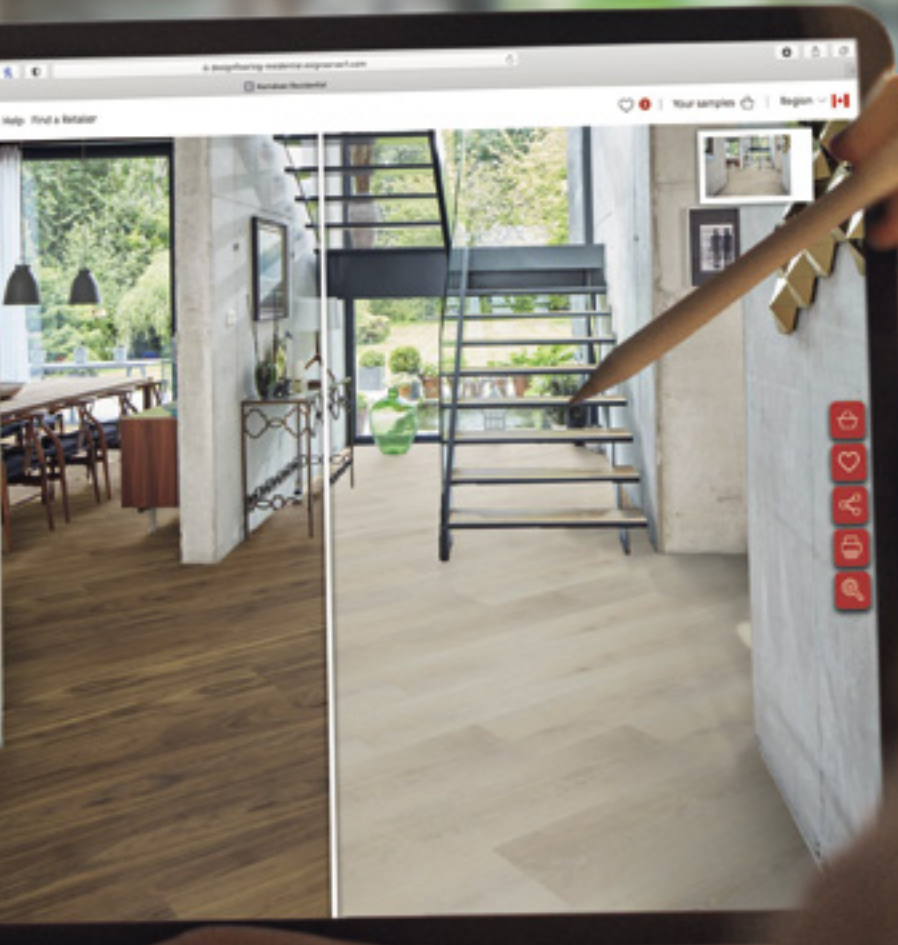



Why LooseLay?

Featuring our K-Wave™ friction grip backing that holds the product in place, Karndean LooseLay creates a strong bond to the subfloor using a combination of weight and friction, with minimal adhesive.

Perfect for temporary and permanent use, Karndean LooseLay is ideal if you are interested in changing out the floor frequently or reducing noise transfer to rooms below. In addition, it's quick and easy to install, and can be laid over most existing hard floors.



acoustic qualities

Reduces noise transfer to rooms below. It's quieter than laminate, and perfect for upstairs bedrooms, playrooms or loft conversions.



quick and easy to install

Karndean LooseLay easily installs over flat, smooth, dry and dust free subfloors, meaning a quicker installation and less upheaval for your family.



individually replaceable

Should you need to replace a piece, simply lift the damaged plank or tile and replace with a new one.

LLT201 Colorado



Scan this QR Code or visit karndean.com

OUR PRODUCTS

Karndean Collections

This book is dedicated to the Karndean LooseLay collection. Check out our other product offerings online or request a brochure.

LIFETIME WARRANTY



waterproof

The product's impervious vinyl backing helps ensure that no moisture gets through the floor.

Designed to **perform**

Dish it out. Our floors can take it.

LLP330 Worn Fabric Oak





pet friendly

From muddy paw prints, to household accidents, and anything in-between, Karndean floors are designed with pets in mind. Karndean's surface protection system works as a barrier against scuff marks and stains from our excitable furry friends.



family friendly

Karndean floors offer kids a safe and comfortable space to play, and parents a durable, easy-to-clean surface.

LLP306 Pearl Oak

LIFETIME WARRANTY



quiet

Karndean flooring is quieter underfoot than natural wood and stone products. It will help to absorb sound and reduce the pitter-patter of paws and high heels across the floor.

Designed for **comfort**

Warm, soft and quiet.

LLP335 Weathered American Pine





warm underfoot

Our products are warmer and softer underfoot than natural wood and stone flooring. For extra warmth, Karndean is easily used with underfloor heating systems.

LLP309 Taupe Oak

LIFETIME WARRANTY



durable

All Kardean products carry a lifetime residential warranty. They won't splinter or crack, which means they will carry on performing no matter what life has to throw at them. With many accidents caused by trips and slips, Kardean also helps to avoid trip points and slippery surfaces with commercial grade slip ratings.

Designed with you in **mind**

Practical flooring built to last.

LLT212 **Dakota**





environmentally friendly

Karndean is fully certified to Global GreenTag™ and our adhesives are free from harmful emissions. Ensuring the lowest impact on the environment, this certification means that all our products have been assessed and certified to comply with standards for low-emitting volatile organic compounds and indoor environmental air quality.



low maintenance

Designed for a long, low-maintenance life, our floors have no grime or dirt traps, unlike many of the materials they faithfully replicate.

LLP307 Neutral Oak

Creating *your* perfect floor

It's not just the floor you choose
but the direction you lay it that
makes a lasting impression.



Design your space
CHOOSE A LAYING PATTERN

LLP331 Shadow Fabric Oak



Your Checklist

Choose your room

Living Room

Design your space

CHOOSE A LAYING PATTERN

- Diagonal
- Diagonal with Border
- Herringbone
- Broken Chevron
- Straight Lay

Choose your look

WOOD OR STONE

- Wood
- Stone

Pick your colour

CHOOSE YOUR DESIGN

- Light
- Mid
- Dark

SKU / Product Name

LLP331
Shadow Fabric Oak

Collection Title

Karndean Loose Lay

Notes

Modern living space with herringbone laying pattern wall to wall



2

Choose your look
WOOD OR STONE



3

Pick your colour
CHOOSE YOUR DESIGN

Design *your* space

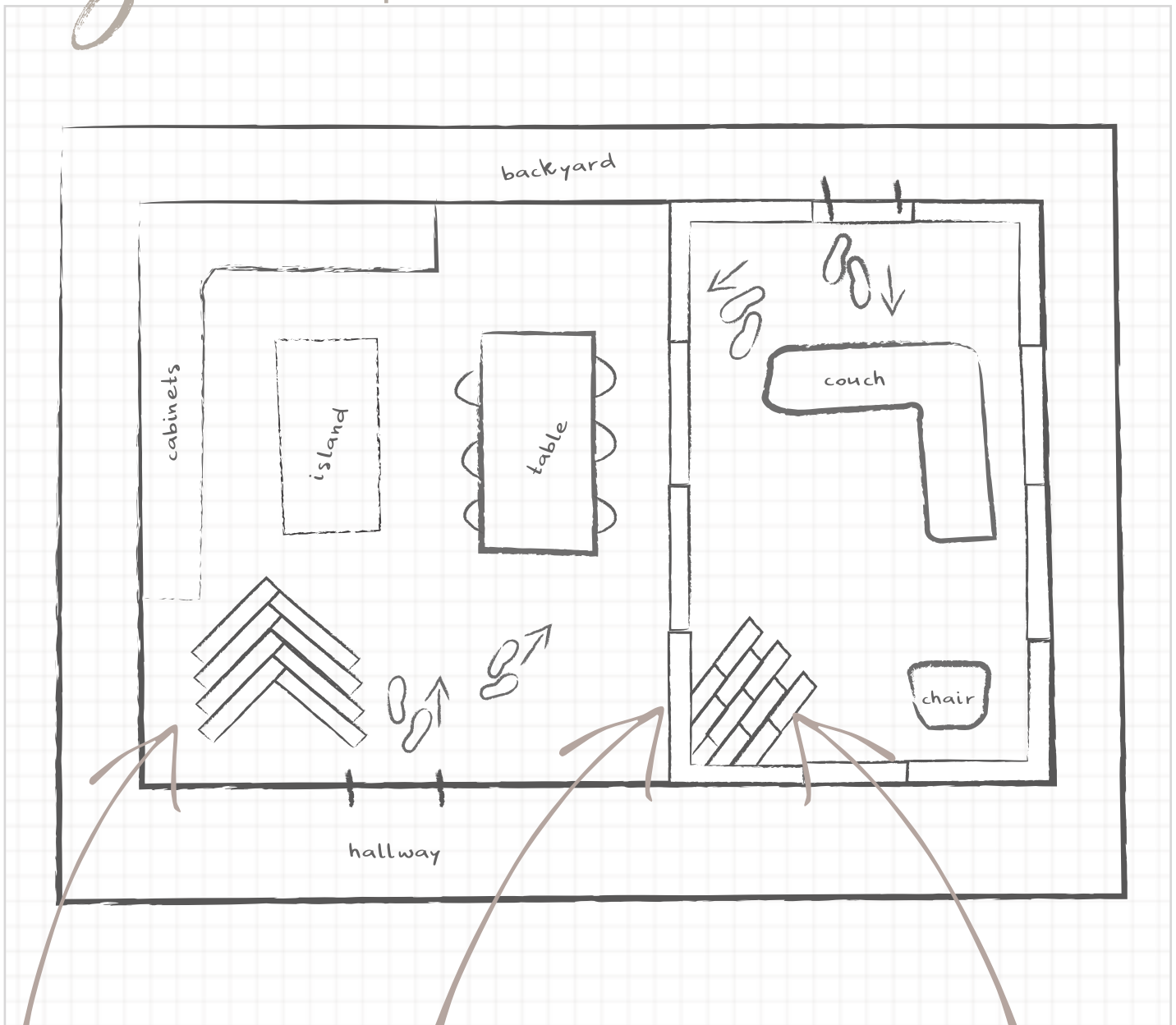

HERRINGBONE WOOD

For this space we chose to lay the floor in a herringbone pattern. As you can, see the planks are pointing both into the kitchen and towards the living room. This helps to draw guests into the room in both potential directions of travel.

BORDER

Knowing that we are not updating the adjoining rooms or hallways, and wanting to create separation from the kitchen to the living area, we added a border to frame the room. A plank border helps to zone each area and frame the newly renovated room.

PLANKS ON A 45°

We chose to lay the planks on a 45 degree angle as we knew people would be travelling into the living room, both from the kitchen and the back door. No matter your entry point, you are still being drawn into the room.

Karndean Process

What's the shape of your space?

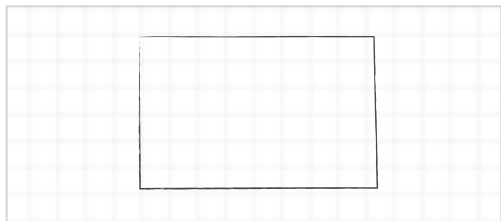

Where are the entry points?

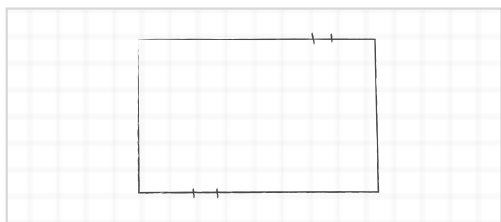

How do you enter the room?

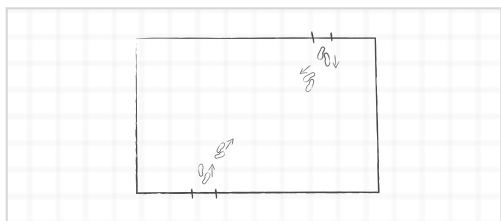

Are you updating rooms around it?

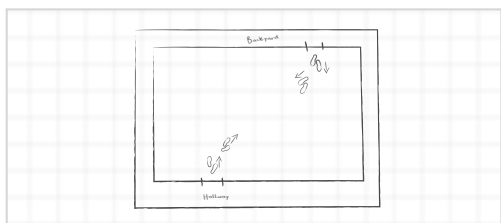

Is there any furniture that you're keeping in the renovation?

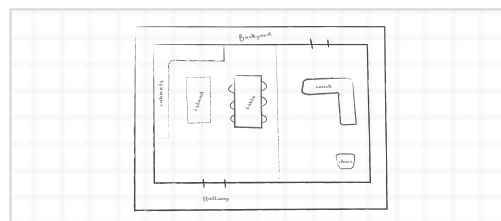

Laying Patterns

Remember to ask yourself questions like: is it an open area? How will the flooring transition from one room to another? To pattern, or not to pattern?

WOOD PLANKS

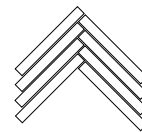

Herringbone



Straight Lay

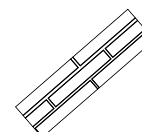

Diagonal

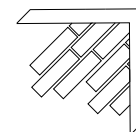

Diagonal with Border

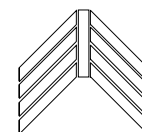

Broken Chevron



Striped 2-Colour

STONE TILES

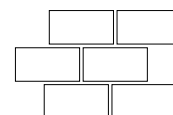

Brick Lay



Stacked

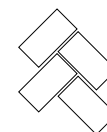

Herringbone

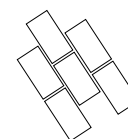

Diagonal

Design *your* space

NOW IT'S YOUR TURN. JOT DOWN ANY INSPIRATION.

Your Checklist

Choose your room

Design your space

CHOOSE A LAYING PATTERN

- Diagonal
- Diagonal with Border
- Herringbone
- Broken Chevron
- Straight Lay

Choose your look

WOOD OR STONE

- Wood
- Stone

Pick your colour

CHOOSE YOUR DESIGN



Light Mid Dark



SKU / Product Name

Collection Title

Notes

Get social with us

We want to know about your design journey and help you along the way

   @karndean_canada

Karndean
LooseLay

LOOSE LAY

Karndean LooseLay
in *your* home

LLP335 Weathered American Pine

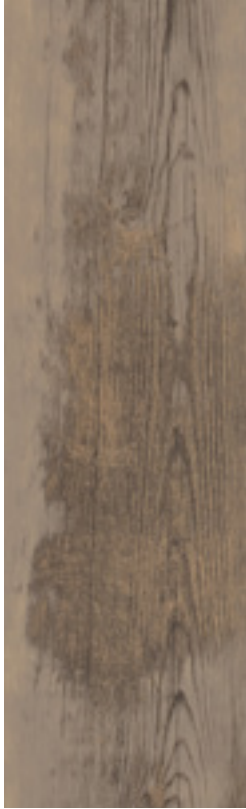

LLP335
**Weathered
American Pine**

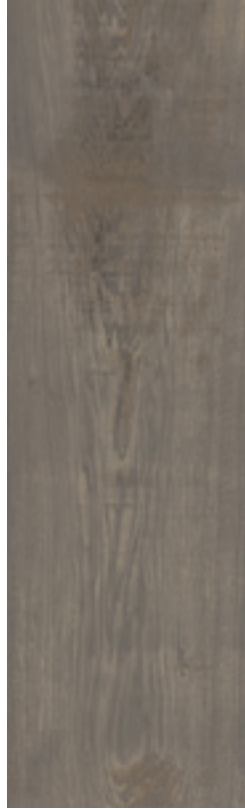

LLP336
**Distressed
American Pine**



BEHIND THE DESIGN

American Pine

Our American Pines were developed from a barn in Pennsylvania's Allegheny Mountain region. These barns were used for drying tobacco in the late 1800's and early 1900's, inspiring the colouring and the aged character of our design. Uneven wear in the original varnish created Mottling Marks.



Scan this QR Code or visit
karndean.com/looselayresidential

LLP336 Distressed American Pine

Karndean
LooseLay

LOOSE LAY

LLP333 Vanilla Oak

Traditional European Oak is a subtle wood with soft features and grain structure. The neutral colour and delicate variation within Vanilla Oak is an ideal neutral floor, allowing you to style the rest of your home to suit a multitude of tastes, without competing with the floor.



Tino

LLT208

20" x 24"



Seattle

LLT214

20" x 24"



Colorado

LLT201

20" x 24"



Ontario

LLT218

20" x 24"

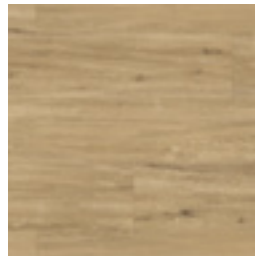

Champagne Oak

LLP310

59" x 10"

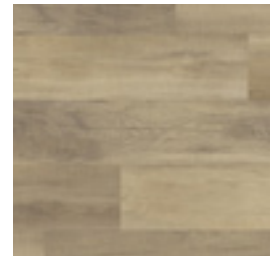

Worn Fabric Oak

LLP330

59" x 10"



Vermont

LLT217

20" x 24"

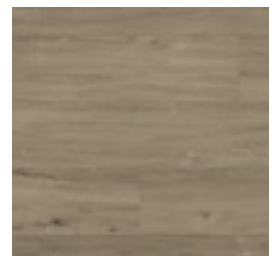

Taupe Oak

LLP309

59" x 10"

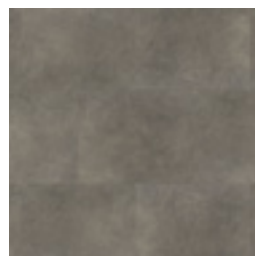

Dakota

LLT212

20" x 24"

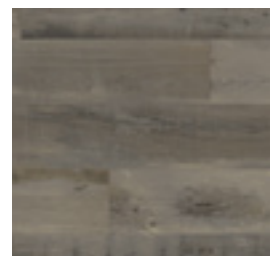

Distressed American Pine

LLP336

59" x 10"

Karndean LooseLay in *your* home



Capri
LLT209 20" x 24"

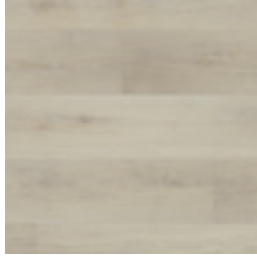

Vanilla Oak
LLP333 59" x 10"

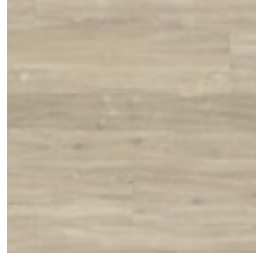

Pearl Oak
LLP306 59" x 10"



Weathered Heart Pine
LLP304 59" x 10"



French Grey Oak
LLP308 59" x 10"



Shadow Fabric Oak
LLP331 59" x 10"



Lemon Spotted Gum
LLP317 59" x 10"



Neutral Oak
LLP307 59" x 10"

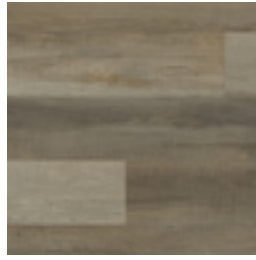

Urban Fabric Oak
LLP332 59" x 10"

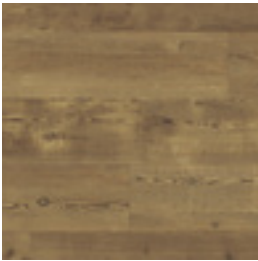

Reclaimed Heart Pine
LLP305 59" x 10"



Weathered American Pine
LLP335 59" x 10"



Twilight Oak
LLP301 59" x 10"

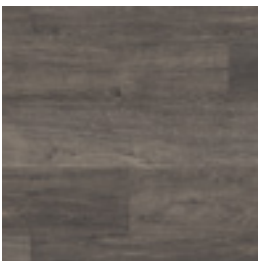

Raven Oak
LLP302 59" x 10"

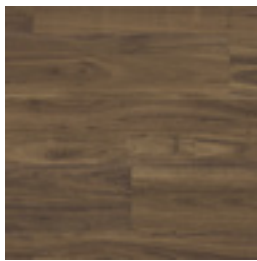

Character Walnut
LLP315 59" x 10"



Antique Heart Pine
LLP303 59" x 10"



Montana
LLT203 20" x 24"

LIGHT



MID



DARK



Formats Explained

KARNDEAN LOOSELAY

Featuring our K-Wave™ friction grip backing that holds the product in place, Karndean LooseLay creates a strong bond to the subfloor using a combination of weight and friction, with minimal adhesive. Perfect for temporary and permanent use, Karndean LooseLay is ideal if you are interested in changing out the floor frequently or reducing noise transfer to rooms below. In addition, it's quick and easy to install and can be laid over most existing hard floors. This brochure is dedicated to the Karndean LooseLay collection. For more design options browse our additional product formats below.

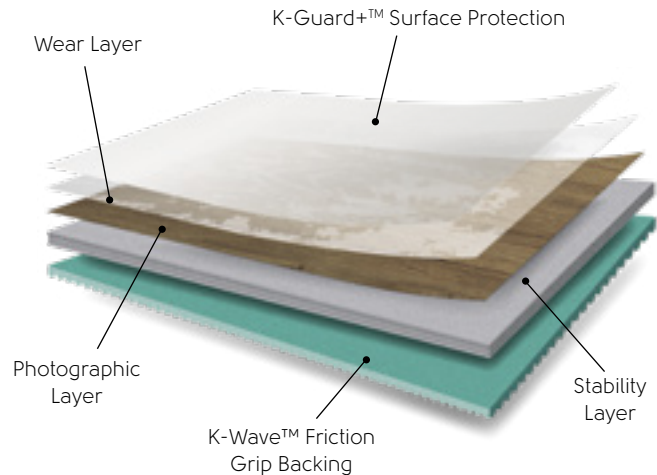

KARNDEAN GLUEDOWN

Our gluedown floors not only look authentic but allow for the most customization. From the distinctive texture of handscraped hickory to the intricate patterns of quarried stone, each floor mimics its natural counterpart. Gluedown floors can be installed in multiple laying patterns and be paired with design features that allow for personalization, so your individual style can shine through. Learn more in our Gluedown Brochure.

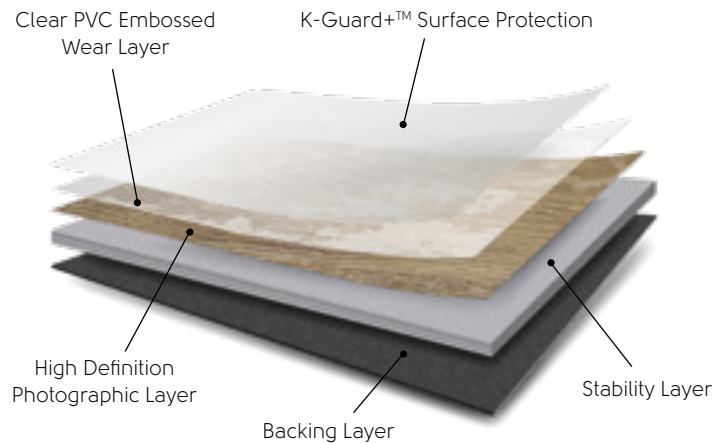

KARNDEAN RIGID CORE

Rigid core is a type of floating floor that clicks and locks into place, no adhesive necessary. Rigid core can be installed over most existing hard floors, meaning less upheaval in your home during installation. An ideal alternative to laminate and engineered hardwood floors, rigid core offers the same realistic look, but with the durability and waterproof qualities of luxury vinyl. Learn more in our Rigid Core Brochure.

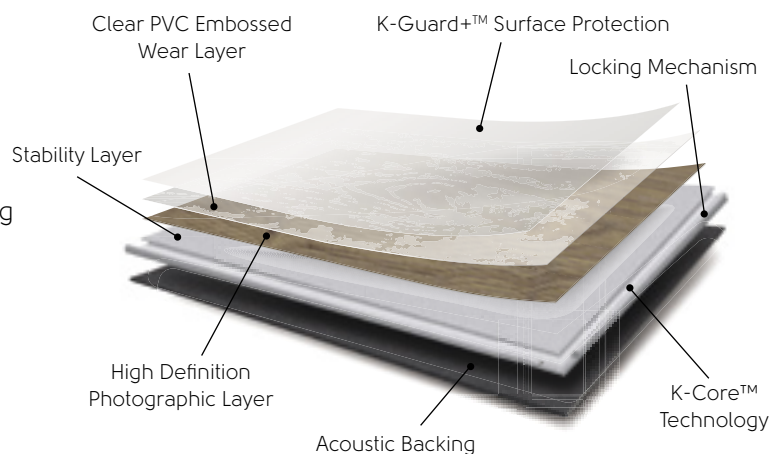

Next Steps

Find your nearest retailer

Shop local and get expert advice at our Karndean retailers. Simply enter your postal code on Karndean.com to find your local Karndean retailer.

karndean.com/findaretailer



Order samples

Designed to help you pick which product is right for you. Order free 4" x 4" samples online right to your home.

karndean.com/samples



Request photography

Saw a swatch of a colour you like? Want to see what it looks like in a home? Simply email us the colours you like and we will send you photos of your favourite designs.

info@karndeancanada.ca



Try our design tools

Become a designer yourself with our interactive digital tool Floorstyle. Upload a photo of your space then sort through designs, compare looks and play with laying patterns.

karndean.com/floorstyle



Connect with us

We are constantly updating with new designs and innovations, so stay up to date by following us online. Share and connect with us through social media, so we can see your Karndean renovations.

   [@karndean_canada](https://www.instagram.com/karndean_canada)



DISCLAIMER

Colour & Pattern Reproduction

All our products are inspired by things we have seen in nature. Just as variation in both colour and detail are part of the beauty of nature so too are some of our designs. This means that with some of our products you will see natural variation when your floor is laid.

We are continually developing new ideas and improving on our existing designs. This does mean that sometimes products are withdrawn on short notice.

Karndean Designflooring owns all its designs and are protected by copyright.

Contact us...

Karndean Designflooring Canada

Call: 866-819-6825

Email: info@karndeancanada.ca

*Calls may be recorded for training and quality purposes.

Front cover: LLP336 **Distressed American Pine**

Back cover: LLP317 **Lemon Spotted Gum**

3250 Harvester Road, Unit 3 Burlington, ON L7N 3W9



Karndean
Designflooring

www.karndean.com

I think I found *my* home

Karndean Designflooring Canadian Showroom
3250 Harvester Road, Unit 3 Burlington, ON L7N 3W9
info@karndeancanada.ca
1-866-819-6825



Karndean
Designflooring